

# WILSON MARBLE INC.

PART OF THE NORTHWEST 1/4 OF SECTION 27,  
TWP. 47N., RGE. 3E., ST. CHARLES COUNTY, MISSOURI.

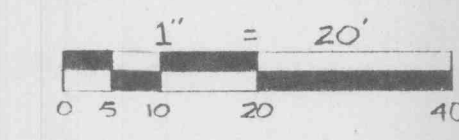

### LOCATION MAP

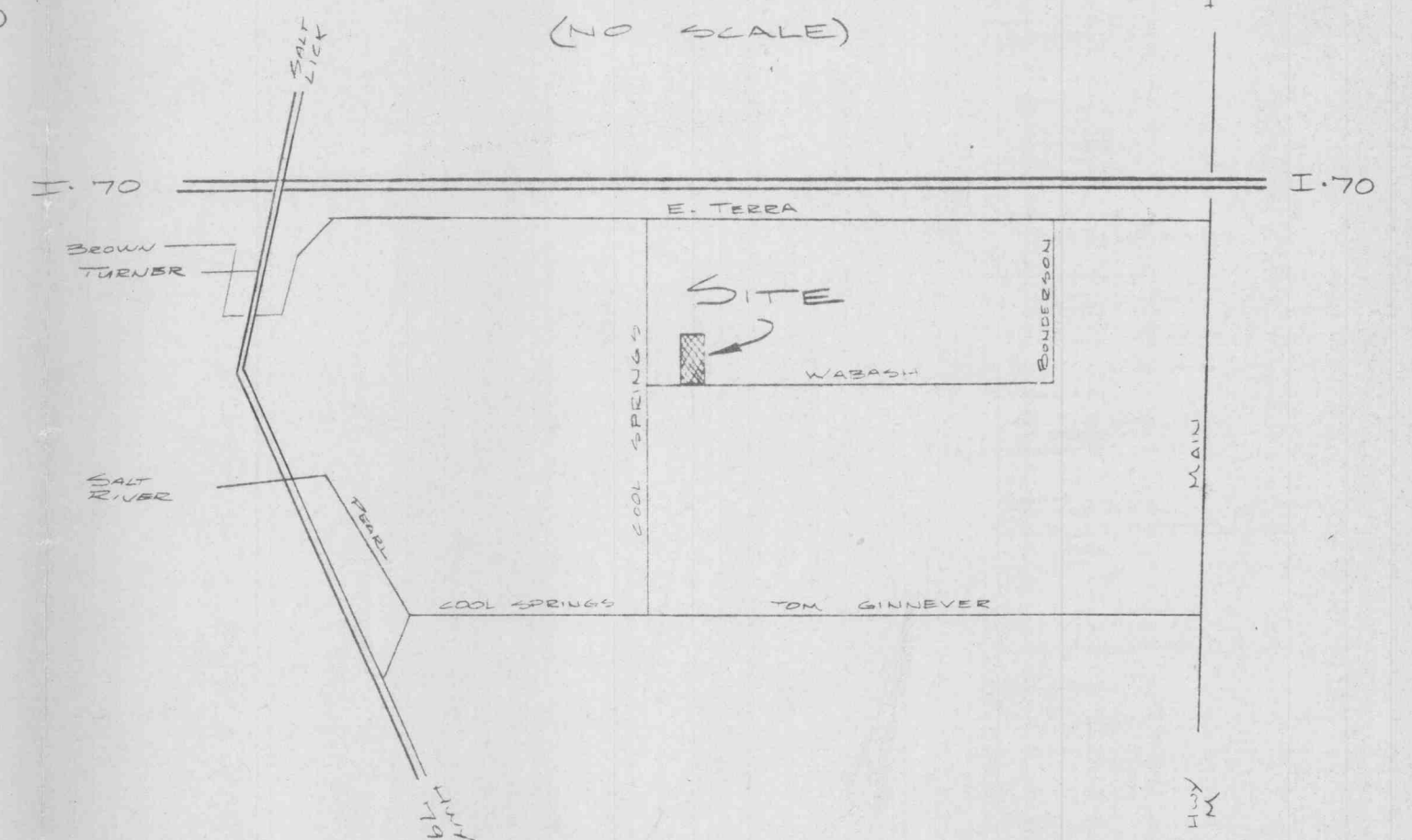

### GENERAL NOTES

- 1.) BENCHMARK: Railroad Spike in Power Pole at S.W. corner of Cool Springs Road and Wabash Avenue; Elev. = 496.69
- 2.) Owner: Mike and Kathy Wilson  
1134 E. Wabash  
O'Fallon, Mo.  
240-9177
- 3.) This tract contains 1.37 acres, more or less.
- 4.) No trees will be removed from site.
- 5.) Current zoning of site is I-1, Light Industrial.  
Building Setbacks:  
A.) Front- 30 feet  
B.) Side- 20 feet  
C.) Rear- 35 feet
- 6.) Landscaping and Screening Regulations  
A. One tree for every 40 feet of street frontage 190 feet of frontage = 5 trees.  
There are currently 5 Bradford Pear Trees and 1 Pin Oak along Wabash Ave. One Bradford Pear will be removed.  
B. One tree for every 4,000 square feet of landscaped open space. There is 32,000 square feet of open space requiring 8 additional trees. There are currently 8 Pin Oaks in addition to the trees along the street, all of which are to remain.  
C. The parking lot is less than 65 feet in width so no interior landscaping is required. However, there is an existing 250 foot landscaped island in front of the building with existing shrubery as shown.
- 7.) Parking Requirements  
1 space per employee plus 1 space per 400 square feet of gross office area. There is 1500 square feet office space which requires 4 spaces. There are currently 9 employees. Five more will be added with the new addition requiring 18 spaces which have been provided.
- 8.) Loading/unloading requirements  
One dock for the first 5000 sq. ft. plus one dock for each additional 20,000 sq. ft. there is 10,500 sq. ft. of manufacturing area requiring two docks. Three have been provided.
- 9.) Per FIRM 29183C-0116D this area is not in a flood plain.

### TREE LEGEND

- EX 2" CALIPER (MIN.) PIN OAK
- EX 2" CALIPER (MIN.) BRADFORD PEAR

### NOTE:

Underground utilities and structures have been plotted from available information and therefore, their location must be considered approximate only. It is the responsibility of the individual contractors to notify the utility companies before actual construction.

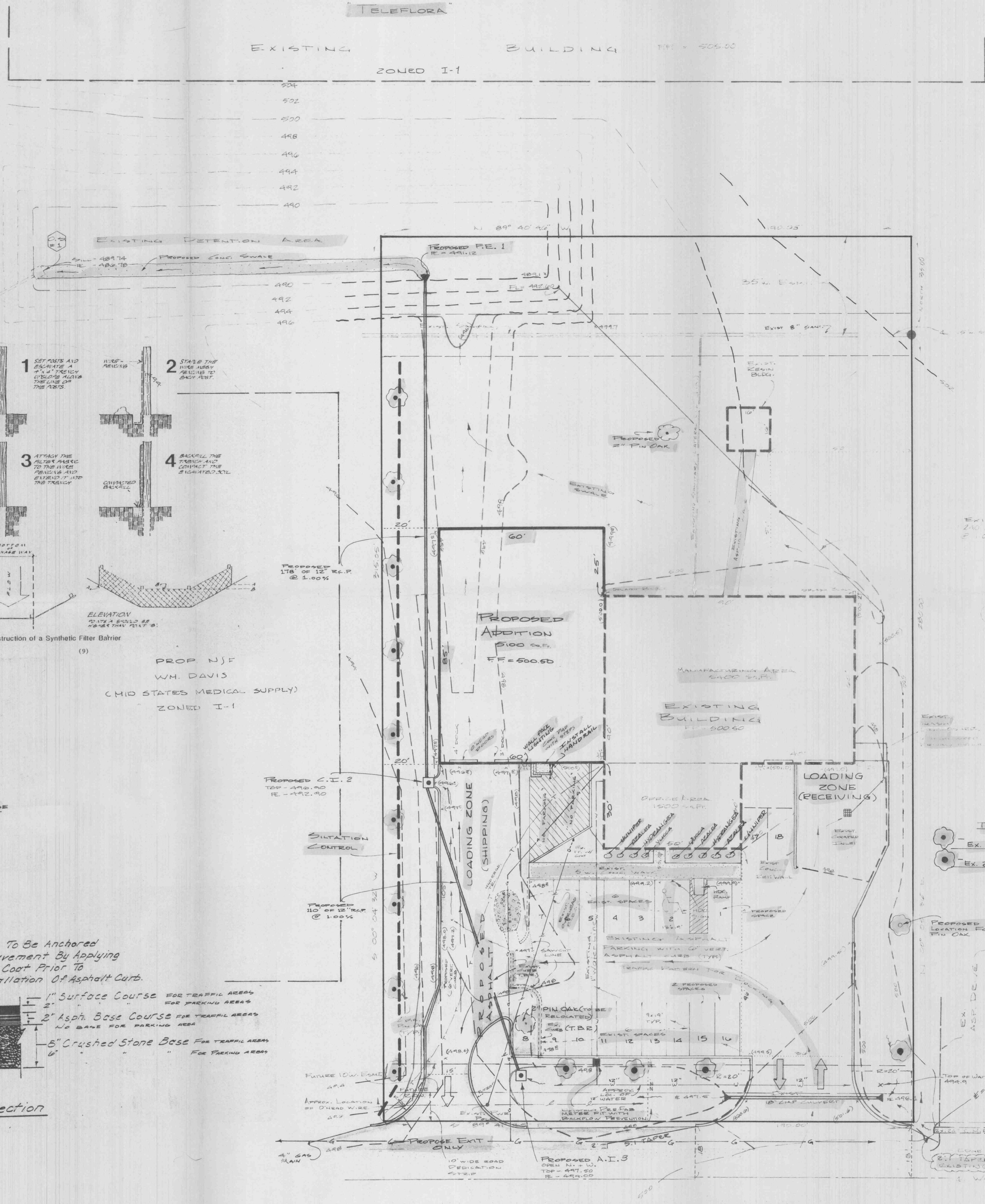
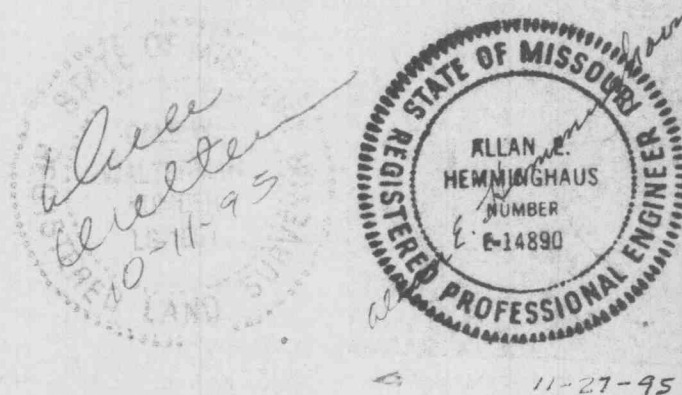

COOL SPRINGS ROAD

- ### Maintenance
1. Filter barriers shall be inspected immediately after each rainfall and at least daily during prolonged rainfall. Any required repairs shall be made immediately.
  2. Should the fabric decompose or become ineffective prior to the end of the expected usable life and the barrier still be necessary, the fabric shall be replaced promptly.
  3. Sediment deposits should be removed after each storm event. They must be removed when deposits reach approximately half the height of the barrier.
  4. Any sediment deposits remaining in place after the silt fence or filter barrier is no longer required shall be dressed to conform with the existing grade, prepared and seeded.

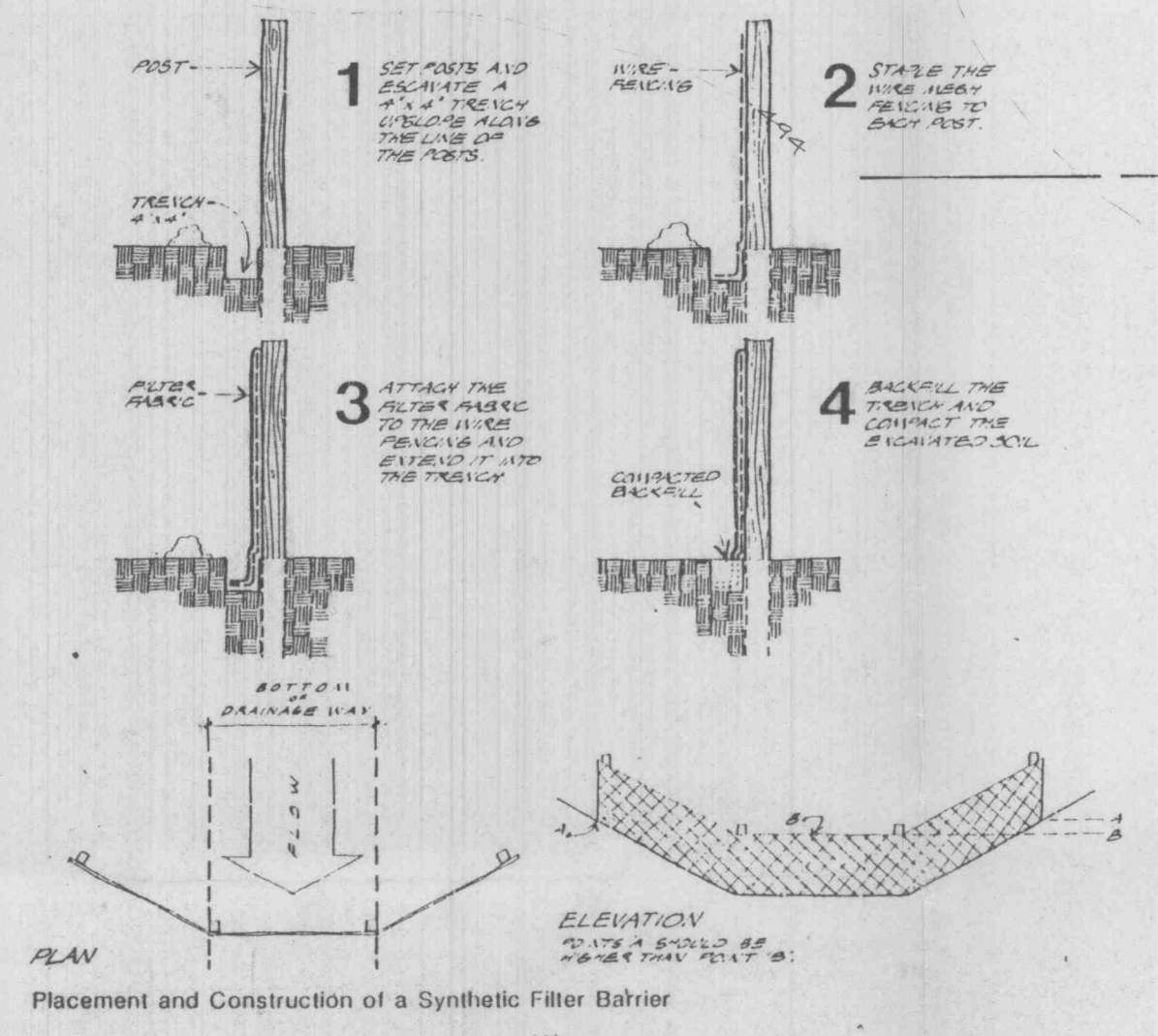

Placement and Construction of a Synthetic Filter Barrier

### H.I.D. WALL MOUNT WEATHER PROOF ENCLOSURE METAL HALIDE

TYPE T  
VOLTAGE 120 V.  
277 V.

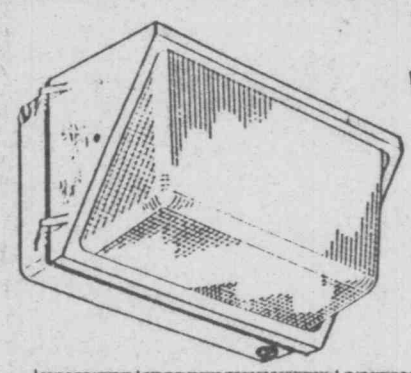

LIGHTING MUST BE SHIELDED AND CAST DOWNWARD

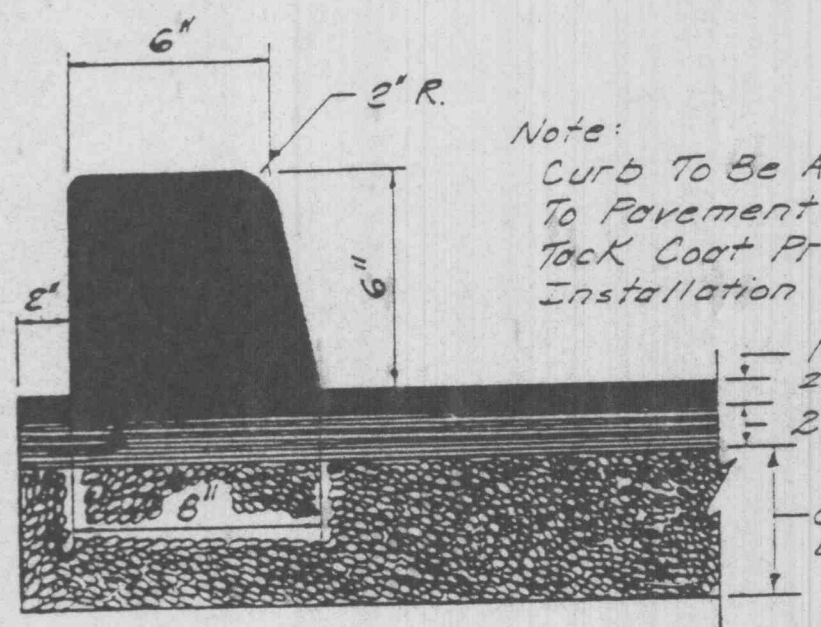

Note: Curb To Be Anchored To Pavement By Applying Tack Coat Prior To Installation Of Asphalt Curb.

Asphalt Curb & Pavement Section  
N.T.S.

Landmark Surveying & Engineering, Inc.  
802 E. Main, Wentzville, MO 63385  
327-5853 • 332-9190  
Troy, MO 64852

### ADDITION TO WILSON MARBLE, INC.

Drawn	LM	Date	0-11-95	SHEET	1 OF 2
Ckd.		Date			
Rev.	Draw	Date	0-19-95		