

Note: The use of high density polyethylene corrugated pipe will be permitted as an acceptable alternative to reinforced concrete pipe. Pipes shall meet A.S.T.M. D-2321 + HDPE TO M-276-91. Concrete manholes and shaft structures shall be required. Pipe must have smooth interior and end to be used inside the public right of way.

All concrete pipe shall be installed with O-Ring rubber type gaskets per M.S.D. Standard Construction Specifications

FINAL SURVEY
DATE
BY
SURVEY PLOTTED
NOTE BOOK TEMPLATE
NO. AREAS CHECKED

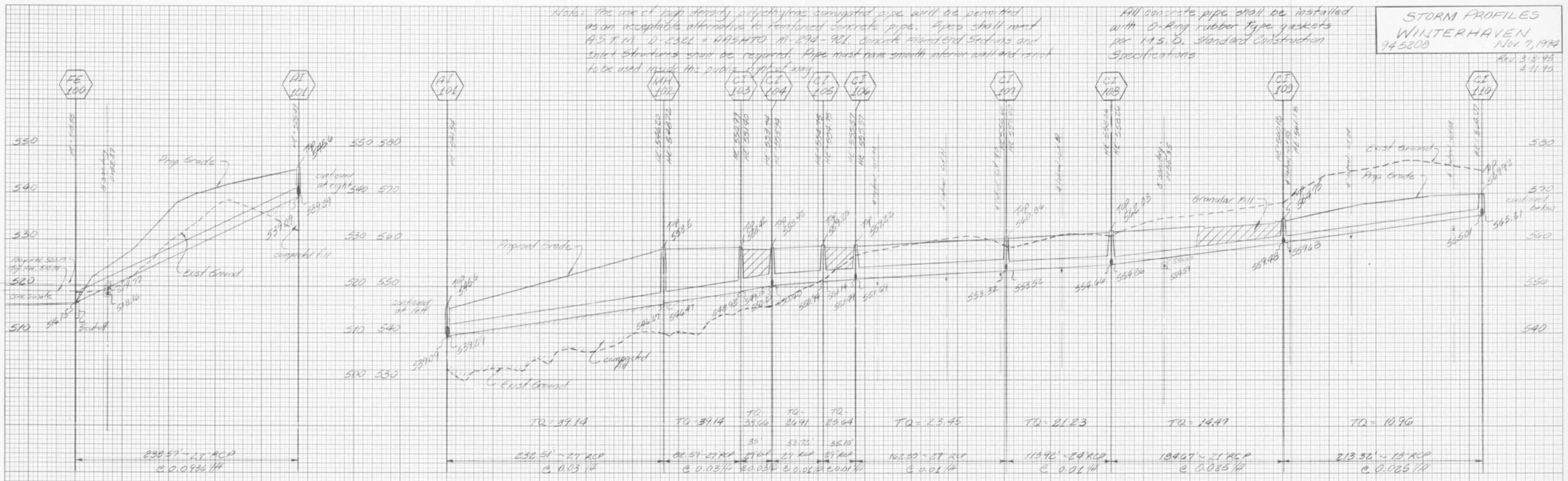

ORIGINAL SURVEY
DATE
BY
SURVEY PLOTTED
NOTE BOOK TEMPLATE
NO. AREAS CHECKED

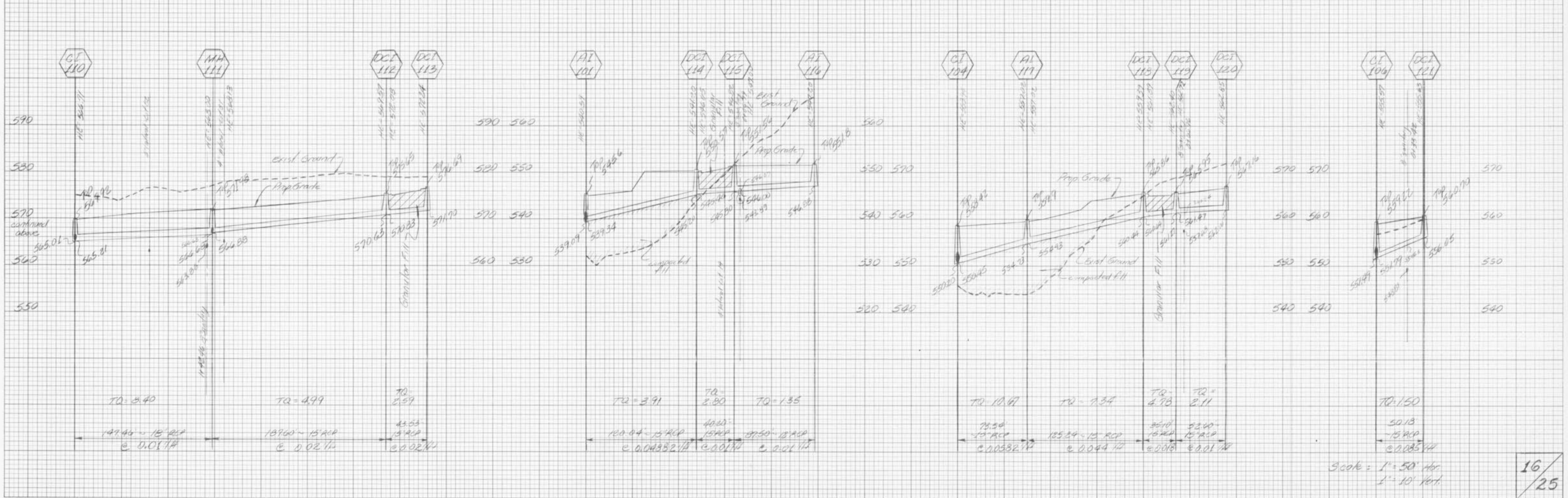

Scale = 1" = 50' Hor
1" = 10' Vert.