

- PCC PAVEMENT NOTES:**
1. CONCRETE SHALL MATCH ADJACENT CONCRETE.
 2. PAVEMENT THICKNESS SHALL MATCH EXISTING. BASE SHALL MATCH EXISTING.
 3. EXPANSION JOINTS AND CONTRACTION JOINTS SHALL BE PLACED AT LOCATIONS SIMILAR TO THE PAVEMENT WHICH WAS REMOVED.
 4. CURB EDGE SHALL BE TOOLED WITH 1/4" RADIUS.
 5. WHERE PAVEMENT IS EXISTING P.C.C., LOW CURB REPLACEMENT SHALL BE DOWELLED INTO EXISTING USING 12" LONG #4 BARS AT 24" CTRS.
 6. CONCRETE SHALL BE 4000 PSI @ 28 DAYS.
- ACC PAVEMENT NOTES:**
1. CONCRETE SHALL MATCH SIDEWALK CONCRETE.
 2. GUTTER THICKNESS & BASE SHALL MATCH ADJACENT PAVEMENT.
 3. EXPANSION JOINTS AND CONTRACTION JOINTS SHALL BE PLACED AT LOCATIONS SIMILAR TO THE ADJACENT CURB AND GUTTER.
 4. CURB EDGE SHALL BE TOOLED WITH 1/4" RADIUS.
 5. CONCRETE SHALL BE 4000 PSI @ 28 DAYS.

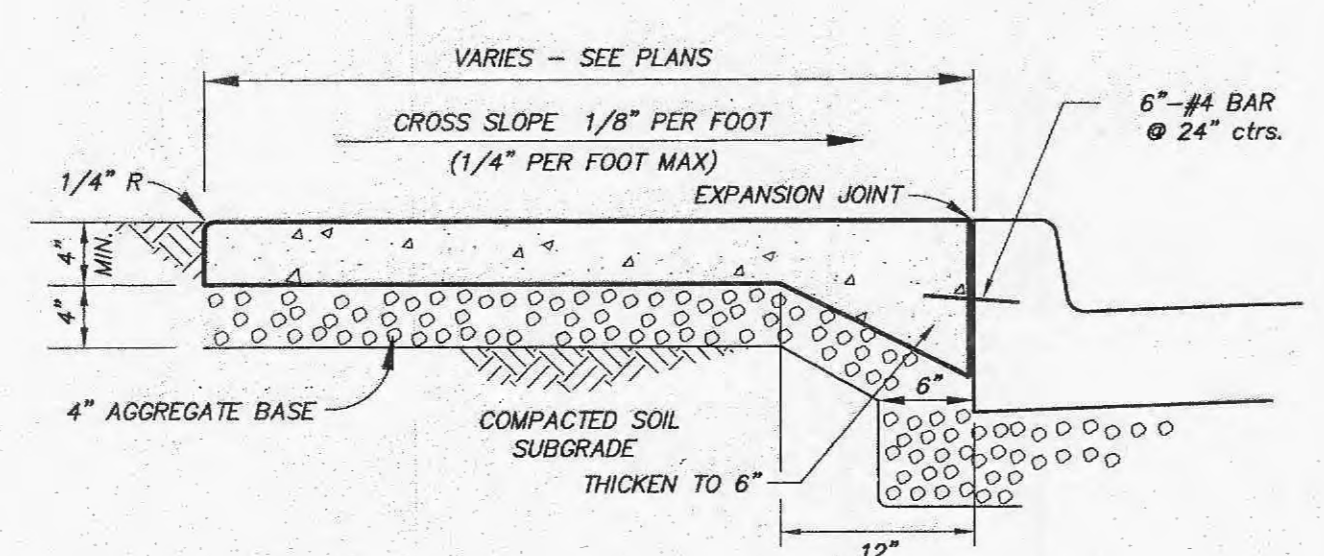

- NOTES:**
1. SIDEWALK SHALL BE 4000 PSI @ 28 DAYS CONCRETE.
 2. INSTALL TRANSVERSE EXPANSION JOINTS TO MATCH STREET OR CURB AND GUTTER EXPANSION JOINTS AND AT ALL DRIVEWAY APPROACHES, FIXED STRUCTURES, BUILDINGS, AND SIDEWALK RAMPS. SPACING SHALL NOT EXCEED 100'.
 3. FOR SIDEWALKS UP TO 6 FT. WIDE, INSTALL TRANSVERSE SAW-CUT JOINTS AT SPACING EQUAL TO SIDEWALK WIDTH.
 4. FOR SIDEWALKS WIDER THAN 6 FT., INSTALL LONGITUDINAL SAW JOINT AT CENTERLINE OR AT A SPACING NOT TO EXCEED 5 FT. TRANSVERSE SAW-CUT JOINT SPACING EQUAL TO HALF SIDEWALK WIDTH.
 5. IF SIDEWALK IS REINFORCED, NO STEEL SHALL BE PLACED THROUGH AN EXPANSION JOINT.

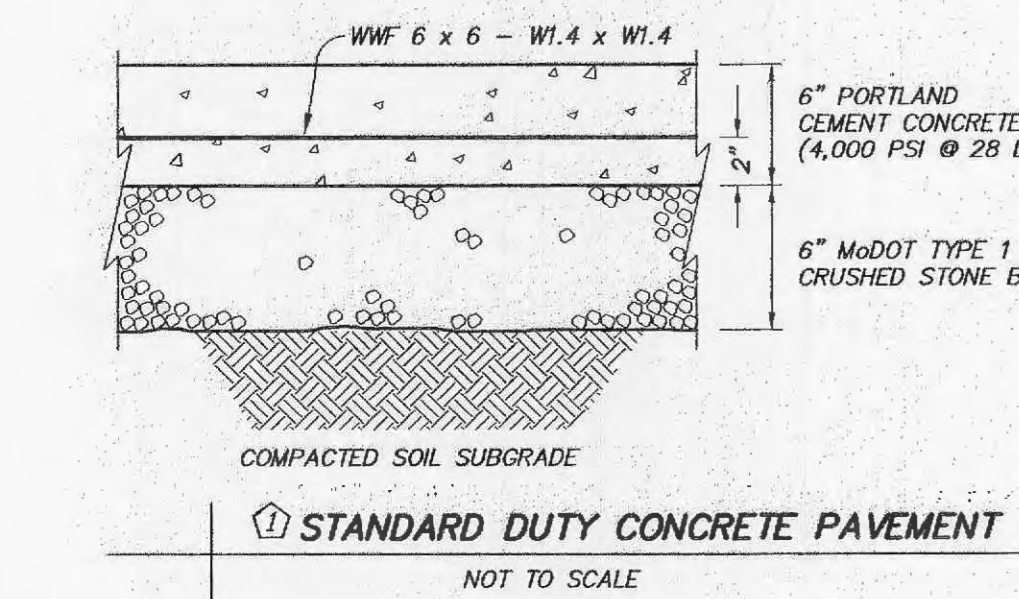
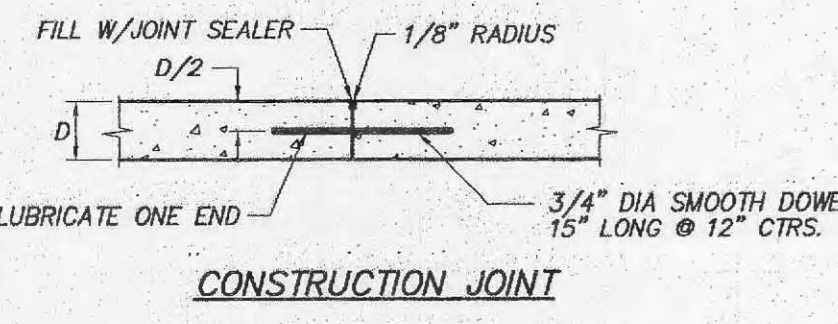
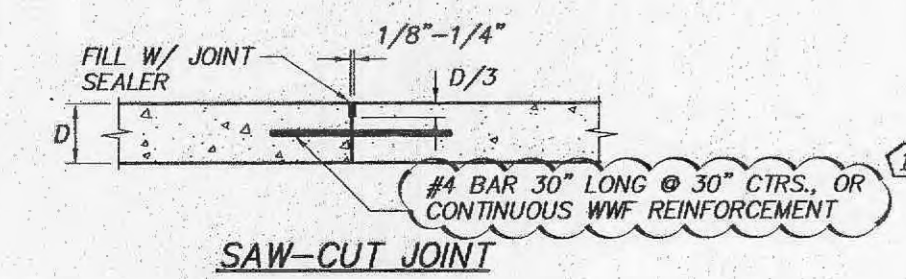
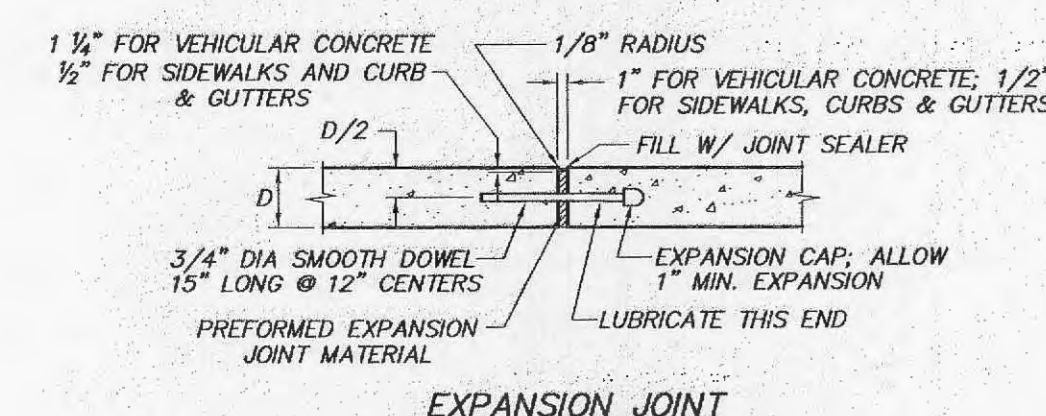

- NOTES:**
1. PRIOR TO CONSTRUCTION, CONTRACTOR SHALL SUBMIT A PAVEMENT JOINT PLAN OF ALL CONCRETE PAVEMENT FOR APPROVAL.
 2. CONCRETE PAVEMENT SHALL HAVE SAW-CUT OR CONSTRUCTION JOINTS EVERY 10 FEET FOR 4 INCH THICK PAVEMENT, 12 FEET FOR 5 INCH THICK PAVEMENT, AND 15 FEET FOR 6 INCH THICK PAVEMENT OR GREATER. PANELS SHALL BE CUT SUCH THAT PANELS ARE NEARLY SQUARE AND DO NOT EXCEED 1.4 LENGTH TO WIDTH RATIO. EXPANSION JOINTS SHALL BE PROVIDED AT ALL FIXED STRUCTURES, SUCH AS: LIGHT STANDARD FOUNDATIONS, SEWER STRUCTURES, BUILDINGS, WALLS, BOTTOM OF STAIRS, ROOF DRAINS, ETC., AND EVERY 150 FEET MAXIMUM. DOWEL BARS SHALL BE PROVIDED AT TRANSVERSE JOINTS IN ALL HEAVY DUTY PAVEMENT DRIVE AISLES, CURBS & GUTTERS, AND SIDEWALKS.
 3. THIS DETAIL APPLIES TO ALL CONCRETE PAVEMENT FOR PARKING LOTS, DRIVE/ACCESS AISLES, CURBS & GUTTERS, AND SIDEWALKS.
 4. INCLUDE BARS WITH TRANSVERSE SAW-CUT JOINTS FOR HEAVY DUTY PAVEMENT. OMIT BAR WITH SAW-CUT JOINTS FOR STANDARD DUTY PAVEMENT AND SIDEWALKS.
 5. PROVIDE CONSTRUCTION JOINT AT END OF DAYS WORK OR IF CONCRETE PLACEMENT IS SUSPENDED FOR MORE THAN 30 MINUTES.
 6. SAW-CUT JOINTS SHALL BE CUT WITHIN 12 HOURS OF INITIAL SET OF CONCRETE. RAVELED JOINTS WILL NOT BE ACCEPTED.
 7. JOINT SEALANT IS REQUIRED FOR ALL JOINTS AND SHALL BE LIGHT GRAY IN COLOR.
 8. OMIT DOWEL BARS FOR EXPANSION JOINTS AT BUILDINGS, LIGHT STANDARDS, AND ROOF DRAINS.

CONCRETE PAVEMENT JOINTS
NOT TO SCALE

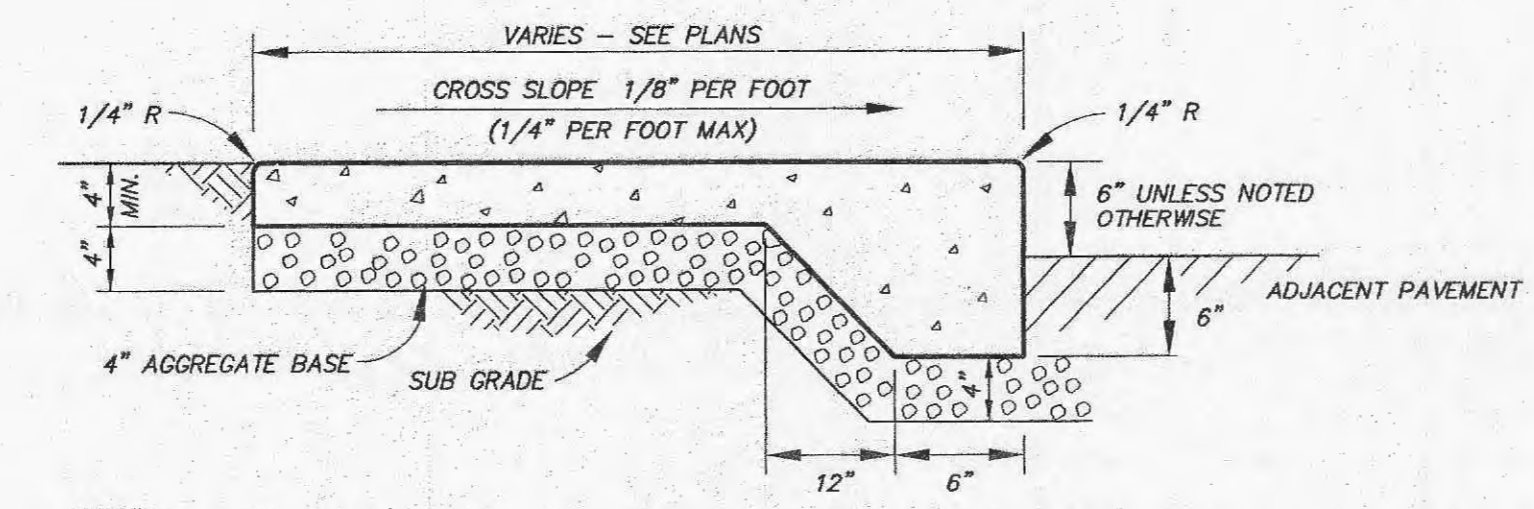

- NOTES:**
1. SIDEWALK SHALL BE 4000 PSI @ 28 DAYS CONCRETE.
 2. INSTALL TRANSVERSE EXPANSION JOINTS TO MATCH STREET OR CURB AND GUTTER EXPANSION JOINTS AND AT ALL DRIVEWAY APPROACHES, FIXED STRUCTURES, BUILDINGS, AND SIDEWALK RAMPS. SPACING SHALL NOT EXCEED 100'.
 3. FOR SIDEWALKS UP TO 6 FT. WIDE, INSTALL TRANSVERSE SAW-CUT JOINTS AT SPACING EQUAL TO SIDEWALK WIDTH.
 4. FOR SIDEWALKS WIDER THAN 6 FT., INSTALL LONGITUDINAL SAW JOINT AT CENTERLINE OR AT A SPACING NOT TO EXCEED 5 FT. TRANSVERSE SAW-CUT JOINT SPACING EQUAL TO HALF SIDEWALK WIDTH.
 5. IF SIDEWALK IS REINFORCED, NO STEEL SHALL BE PLACED THROUGH AN EXPANSION JOINT.

THICKENED CONCRETE SIDEWALK
NOT TO SCALE

SIDEWALK RAMP CURB
NOT TO SCALE

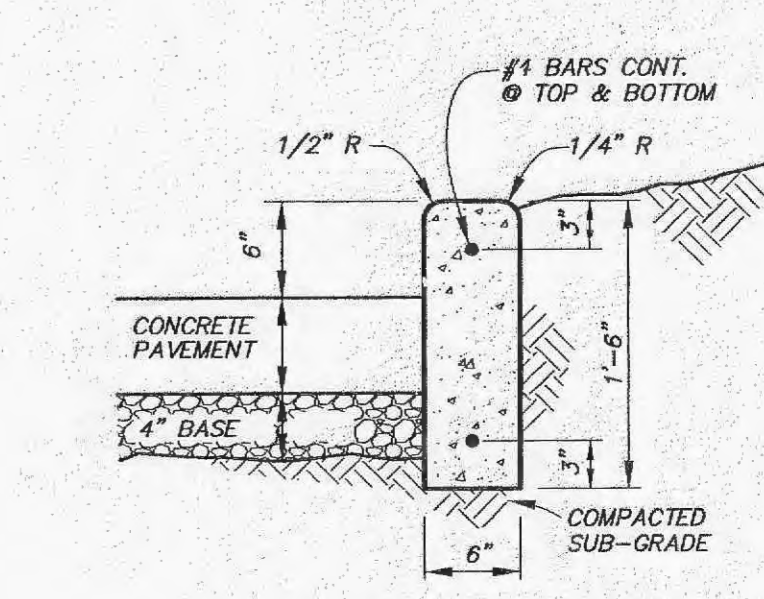
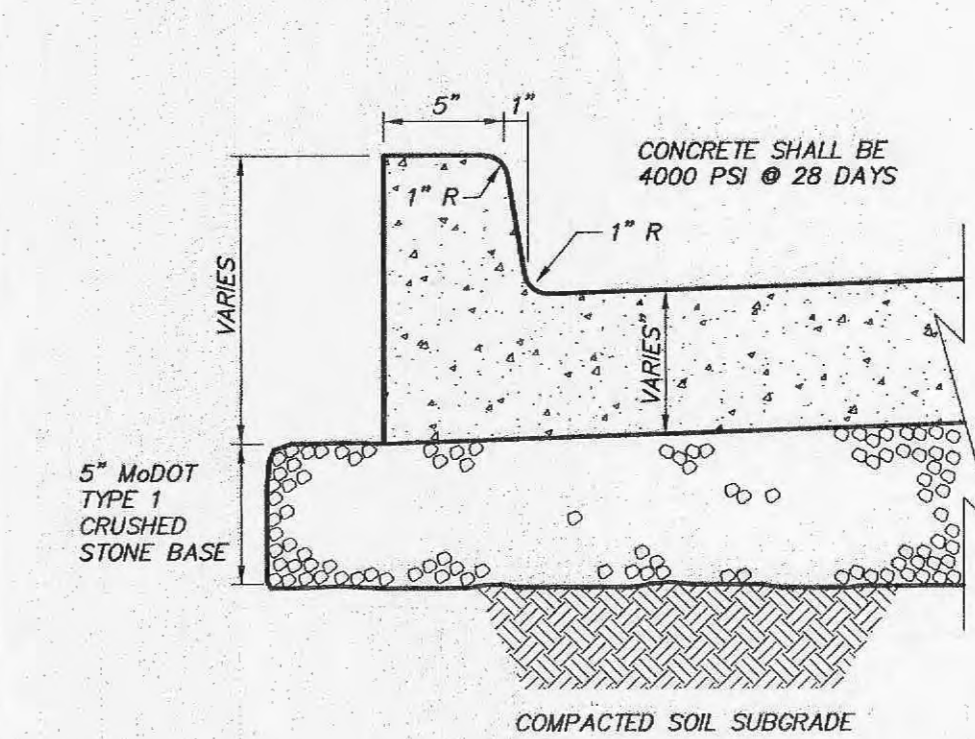

1. PAVEMENT SHALL BE 4,000 PSI @ 28 DAYS CONCRETE.
2. PROVIDE 1" DEEP x 1/4" WIDE CONTROL JOINTS AT MAXIMUM 10' SPACING.
3. PROVIDE 1/2" EXPANSION JOINTS AT MAXIMUM 60' INTERVALS AND AT EXISTING CONCRETE USING #4 BARS x 12" LGT. - TOP AND BOTTOM - PREVENT BONDAGE TO CONCRETE AT ONE END.

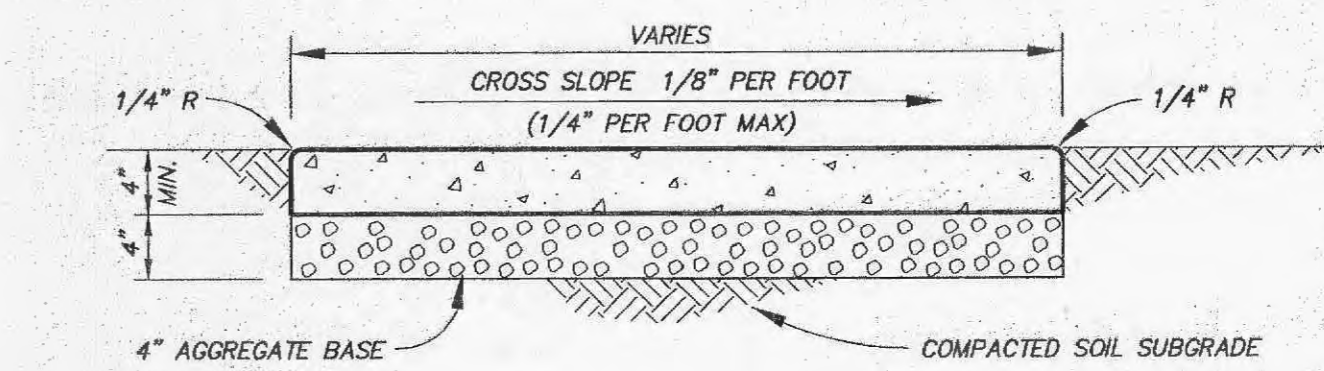

- NOTES:**
1. SIDEWALK SHALL BE PORTLAND CEMENT CONCRETE.
 2. INSTALL TRANSVERSE EXPANSION JOINTS TO MATCH STREET OR CURB AND GUTTER EXPANSION JOINTS AND AT ALL DRIVEWAY APPROACHES, FIXED STRUCTURES, BUILDINGS, AND SIDEWALK RAMPS. SPACING SHALL NOT EXCEED 100'.
 3. FOR SIDEWALKS UP TO 6 FT. WIDE, INSTALL TRANSVERSE SAW-CUT JOINTS AT SPACING EQUAL TO SIDEWALK WIDTH.
 4. FOR SIDEWALKS WIDER THAN 6 FT., INSTALL LONGITUDINAL SAW JOINT AT CENTERLINE OR AT A SPACING NOT TO EXCEED 5 FT. TRANSVERSE SAW-CUT JOINT SPACING EQUAL TO HALF SIDEWALK WIDTH.
 5. IF SIDEWALK IS REINFORCED, NO STEEL SHALL BE PLACED THROUGH AN EXPANSION JOINT.

CONCRETE SIDEWALK
NOT TO SCALE

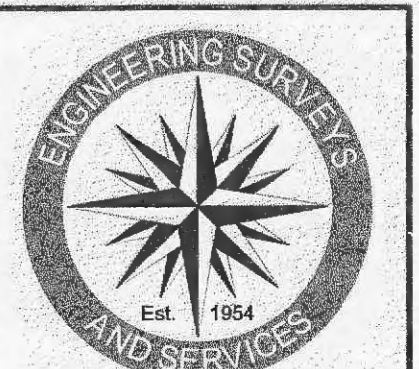

Engineering Surveys and Services
Consulting Engineers, Scientists, and Land Surveyors
Analytical and Material Laboratories
1113 Fry Street, Columbia, Missouri 65201
313-449-2666 - www.ESS-inc.com
Other Offices: Sedalia, Missouri
Jefferson City, Missouri - Sedalia, Missouri
Missouri Engineering Corporation # 260405018

WOODBURY PLACE II
721 WOODLAWN AVENUE
OFALLON, ST. CHARLES COUNTY, MISSOURI

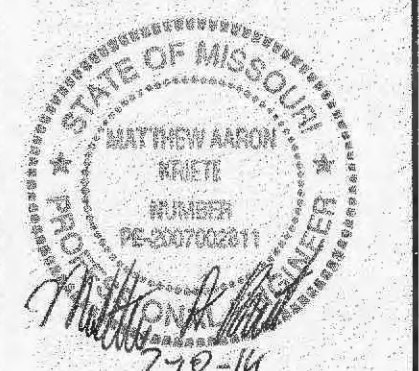

MATTHEW A. KRIETE
PROFESSIONAL ENGINEER
PE-3007002811

Date
MAY 23, 2014

Revised
JULY 18, 2014

Design: TOC Drawn: BR

SITE DETAILS

Sheet

C12.01

ES&S PROJECT NO. 12660