

A SET OF CONSTRUCTION PLANS FOR Wyndgate Village B Plat Two

TRACTS OF LAND BEING PART OF FRACTIONAL
SECTIONS 16 & 17, AND U.S. SURVEYS 61 & 417,
TOWNSHIP 46 NORTH, RANGE 2 EAST,
ST. CHARLES COUNTY, MISSOURI

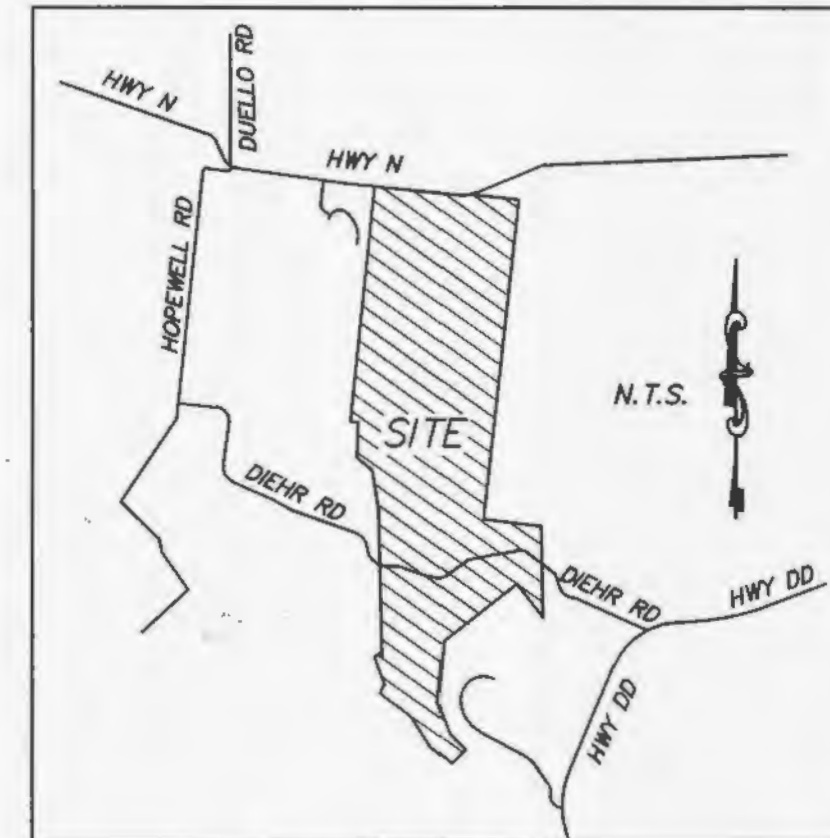

Plan View



Locator Map

Drawing Index

- 1 COVER SHEET
- 2 GENERAL NOTES
- 3 SITE PLAN
- 4 GRADING PLAN
- 5 EROSION CONTROL PLAN
- 6 STREET PROFILES
- 7-8 SANITARY SEWER PROFILES
- 9 STORM SEWER PROFILES
- 10 DRAINAGE AREA MAP
- 11 WATER LAYOUT
- 12 LANDSCAPE PLAN
- 13-14 PAVEMENT DETAILS
- 15 STORM SEWER & SIDEWALK DETAILS
- 16-20 SANITARY SEWER DETAILS
- 21-22 WATER DETAILS
- 23-24 EROSION CONTROL DETAILS

Benchmarks Project

U.S.G.S BENCH MARK
At Dardenne T.46N., R.2E. Near Approx. Corner
Sections 1, 2, 11 & 12. 31' north & 20' west
of crossroads, 49' south of S.E. corner of Catholic Church,
2.0' north of sidewalk & in a concrete post standard
tablet stamped "T1" 60C 1936 616'.

Elev. 616.50

Site

Cut cross "+" at the centerline - centerline
Intersection of Wyndgate Ridge Drive with Parkgate
Drive and Towergate Drive

Elev. 639.91

Legend

Sanitary Sewer (Proposed)	Sanitary Structure	R.C.P.	Reinforced Concrete Pipe	
Sanitary Sewer (Existing)	Storm Structure	C.M.P.	Corrugated Metal Pipe	
Storm Sewer (Proposed)	Test Hole	C.I.P.	Cast Iron Pipe	
Storm Sewer (Existing)	Power Pole	P.V.C.	Polyvinyl Chloride	
Water Line & Size	Light Standard	V.C.P.	Vitrified Clay Pipe	
Existing water line	Double Water Meter Setting	C.O.	Clean Out	
Tee & Valve	Single Water Meter Setting	V.T.	Vent Trap	
Hydrant	C.I.	Curb Inlet	T.B.R.	To Be Removed
Cap	S.C.I.	Skewed Curb Inlet	T.B.R.&R	To Be Removed & Relocated
Lot or Building Number	D.C.I.	Double Curb Inlet	T.B.P.	To Be Protected
Existing Fence Line	G.I.	Grate Inlet	T.B.A.	To Be Abandoned
Existing Tree Line	D.A.I.	Double Area Inlet	B.C.	Base Of Curb
Street Sign/Stop Sign	C.C.	Concrete Collar	T.C.	Top Of Curb
Existing Contour	F.E.S.	Flared End Section	T.W.	Top Of Wall
Proposed Contour	E.P.	End Pipe	B.W.	Base Of Wall
Rip-Rap	E.D.	Energy Dissipater	(TYP)	Typical
End of Lateral	M.H.	Manhole	U.N.O.	Unless Noted Otherwise
Asphalt Pavement	C.P.	Concrete Pipe	U.I.P.	Use In Place
Concrete Pavement	S.A.S.	Sinkhole Access Structure	Street Sign/Yield Sign	
Proposed Swale				

Conditions of Approval From Planning and Zoning

Utility Contacts

Sanitary Sewers
Duckett Creek Sanitary District
3550 Highway K
O'Fallon, MO. 63368
636-441-1244

Water
Public Water Supply District No. 2
P.O. Box 967
O'Fallon, MO. 63366
636-561-3737 Ext. 131

Storm Sewer
City of O'Fallon
100 N. Main St.
O'Fallon, MO. 63366
636-281-2858

Electric
Cuivre River Electric Co.
P.O. Box 160
Troy, MO. 63379-0160
1-800-392-3709

Gas
Laclede Gas Company
6400 Graham Road
St. Louis, MO. 63134
314-522-2297

Telephone
Century Tel
1151 Century Tel Dr.
Wentzville, MO. 63385
636-332-7261

Fire Protection
Wentzville Fire District
209 West Pearce Blvd.
Wentzville, MO. 63385

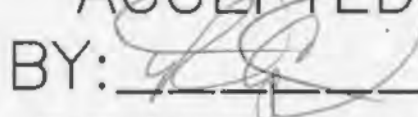
CITY OF O'FALLON
COMMUNITY DEVELOPMENT DEPARTMENT
ACCEPTED FOR CONSTRUCTION
BY:  DATE April 11, 2014
PROFESSIONAL ENGINEER'S SEAL
INDICATES RESPONSIBILITY FOR DESIGN

PROJECT TITLE
**WYNDGATE VILLAGE B
PLAT TWO**

PICKETT, RAY & SILVER INC.
CIVIL ENGINEERING, LAND SURVEYING,
AND NATURAL RESOURCES SERVICES
St. Peters
22 Richmond Center Court
St. Peters, MO 65376
Phone (636) 397-1211
www.prs3.com
Branston
110 West Adams, Suite 201
Branston, MO 66616
Fax (636) 397-1104
1-800-708-3818

ENGINEER'S AUTHENTICATION
THE RESPONSIBILITY FOR PROFESSIONAL
ENGINEERING LIABILITY ON THIS PROJECT
IS HEREBY LIMITED TO THE SET OF PLANS
AUTHENTICATED BY THE SEAL, SIGNATURE,
AND DATE HEREBY ATTACHED.
RESPONSIBILITY IS DISCLAIMED FOR ALL
OTHER ENGINEERING PLANS INVOLVED IN
THIS PROJECT AND SPECIFICALLY
EXCLUDES REVISIONS AFTER THIS DATE
UNLESS REAUTHENTICATED.

DOUGLAS S. TIDMAN
PROFESSIONAL ENGINEER LICENSE E-23345

Developer / Owner Information
McBride Wyndgate, LLC
16091 Swingley Ridge Road, Suite 300
Chesterfield, Missouri 63077
CONTACT:
Mr. Jeremy Roth
314-336-0775
314-336-0775 Fax
City of O'Fallon Cover Sheet

P+Z No. 3203

City No.

Page No.

1 of 24

V:\095-281011\p\01010101\01010101.dwg 2017/06/14 10:12:17 AM