

SCALE: 1"=50' HORIZONTAL
1"=10' VERTICAL

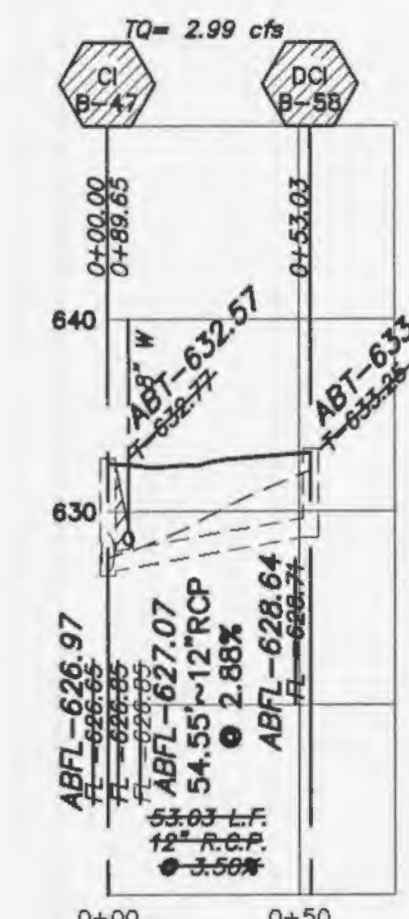
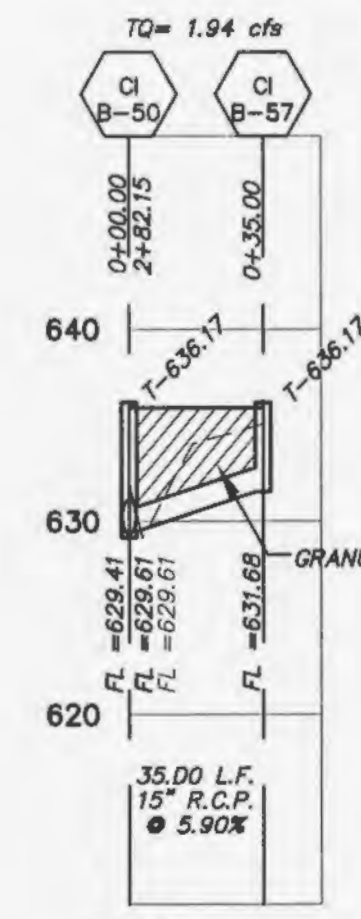
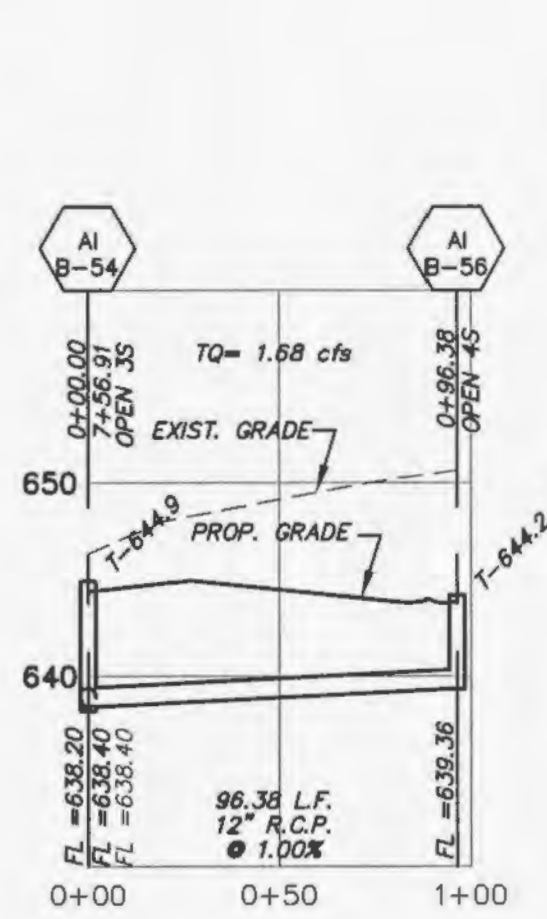
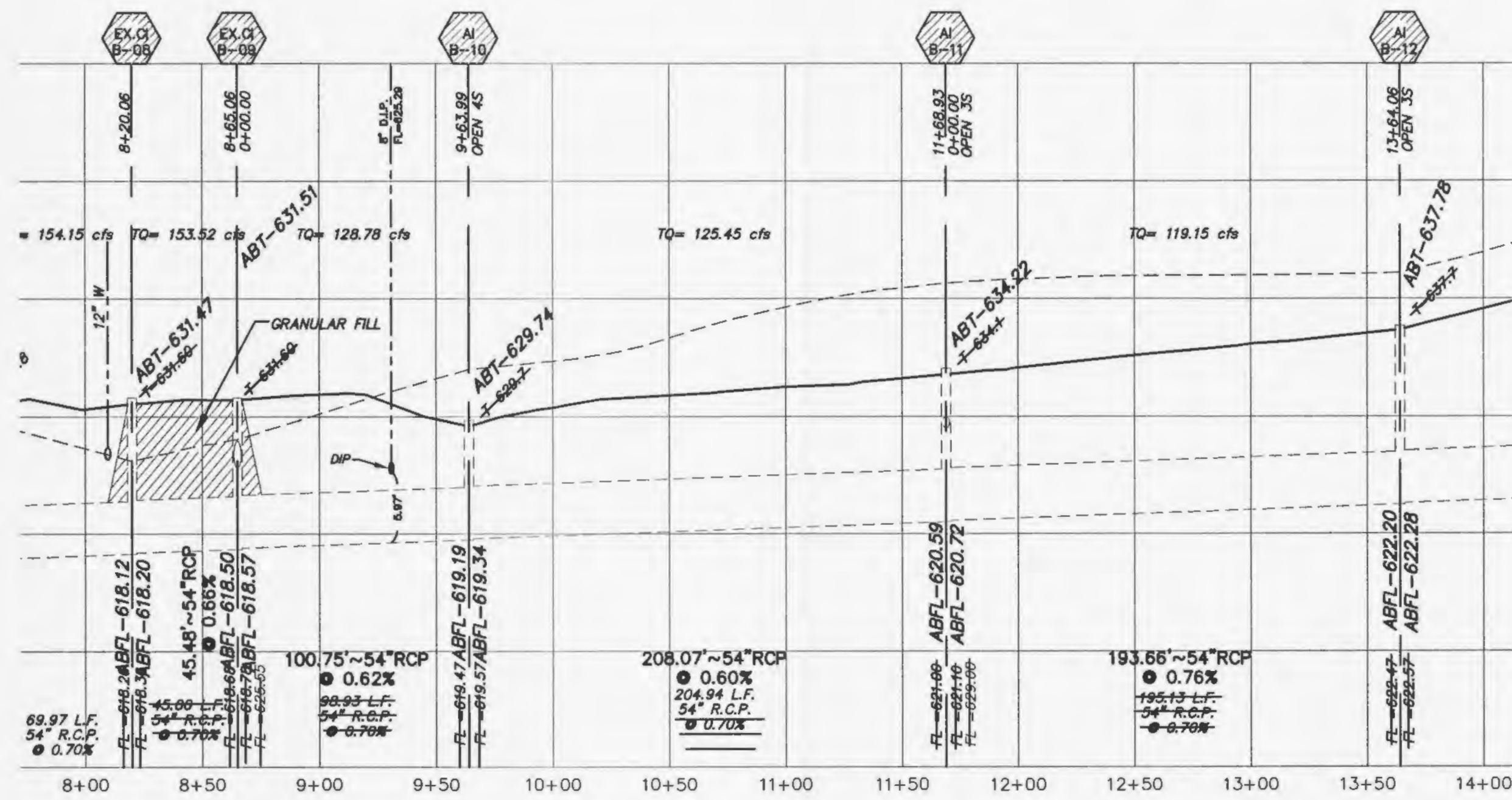

STORM SEWERS WHICH CROSS OVER EXISTING OR PROPOSED SANITARY SEWER TRENCHES SHALL BE CRADLED IN CONCRETE (OR ENCASED H.D.P.E.) THROUGH THE FULL WIDTH OF THE SANITARY SEWER TRENCH. THE TRENCH SHALL BE BACKFILLED AND COMPACTED GRANULAR FILL TO THE BOTTOM OF THE CONCRETE CRADLE.

IF THE STORM AND SANITARY SEWERS ARE PARALLEL AND IN THE SAME TRENCH OR OVERDIP, THE UPPER SHALL BE PLACED ON A SHELF AND THE LOWER SHALL BE BEDDED IN COMPACTED GRANULAR FILL TO THE FLOW LINE OF THE UPPER.

NOTE: NEW CURB INLETS ARE TO BE EQUIPPED WITH TRITON® OR APPROVED EQUIVALENT WATER TREATMENT INSERTS. UNITS ARE TO BE INSTALLED AFTER ALL HOME CONSTRUCTION IN DRAINAGE AREA IS COMPLETE AND SITE IS STABILIZED. SEE DETAIL SHEET 24.

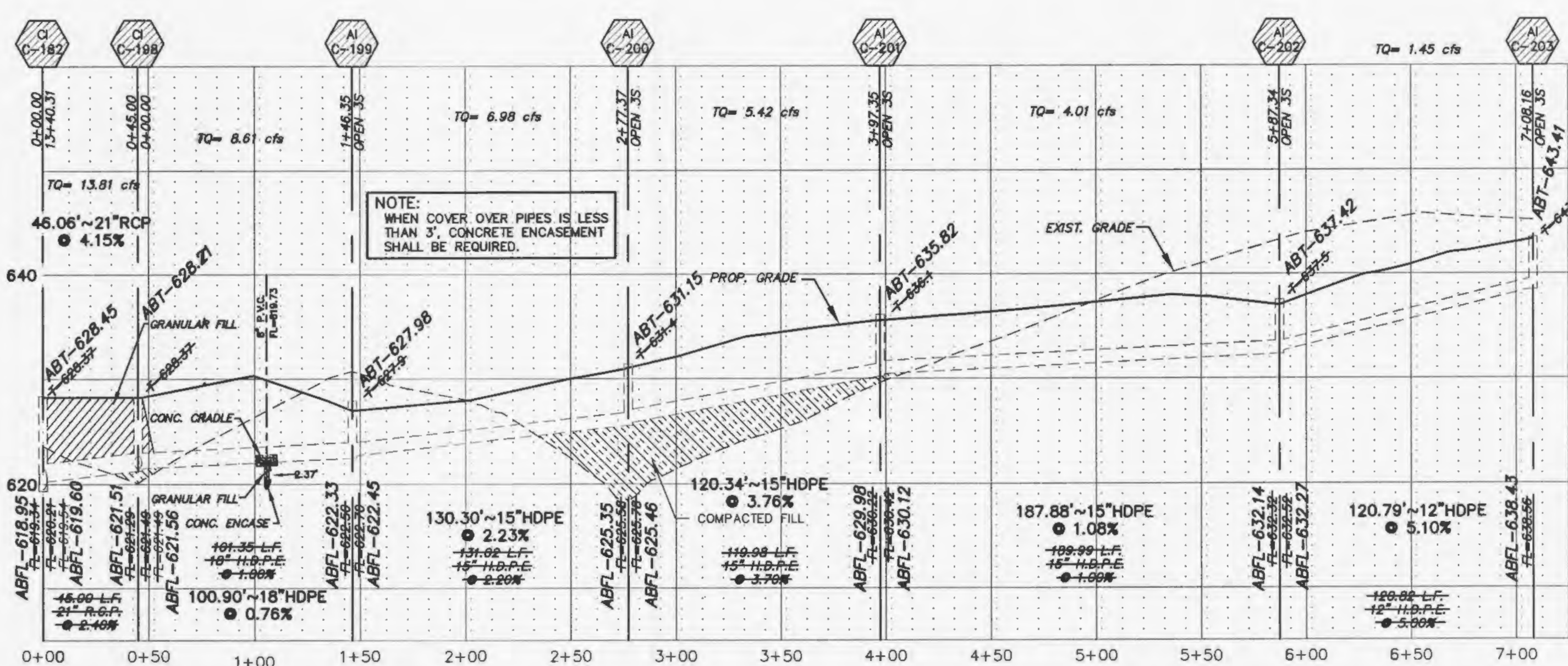
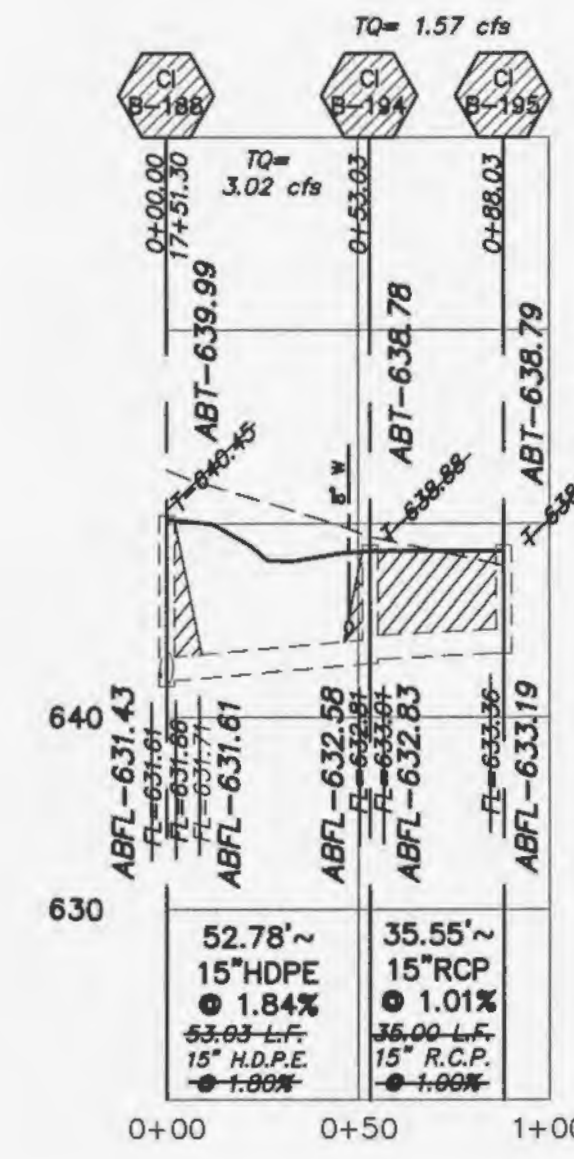
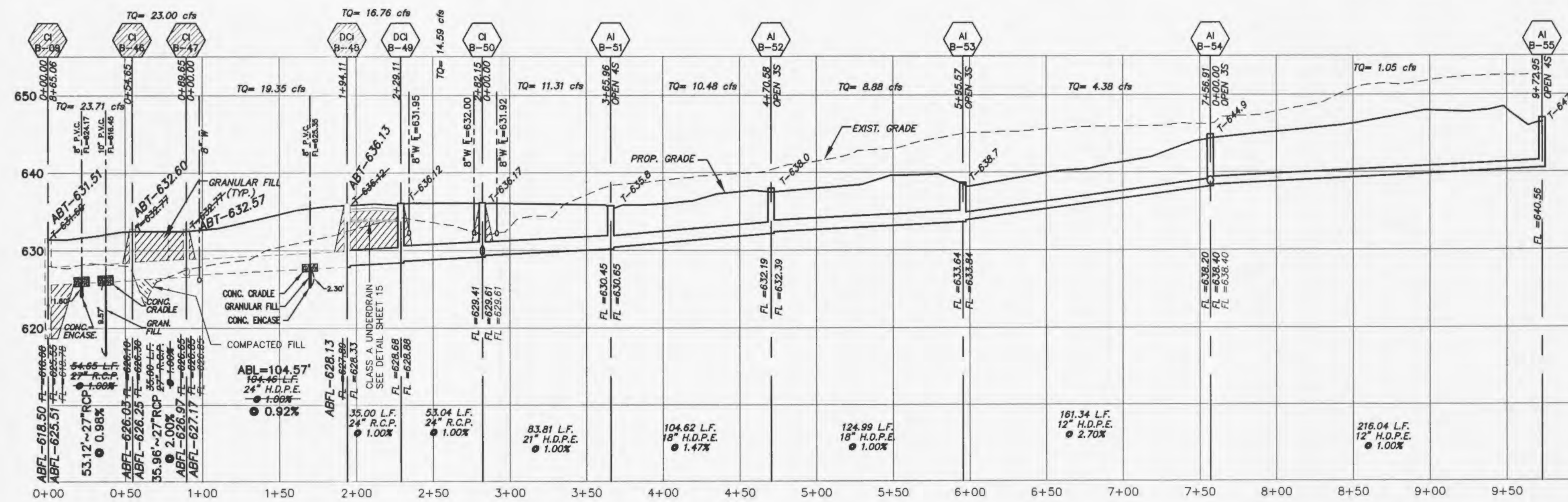

NOTE:
WHEN COVER OVER PIPES IS LESS THAN 3', CONCRETE ENCASEMENT SHALL BE REQUIRED.

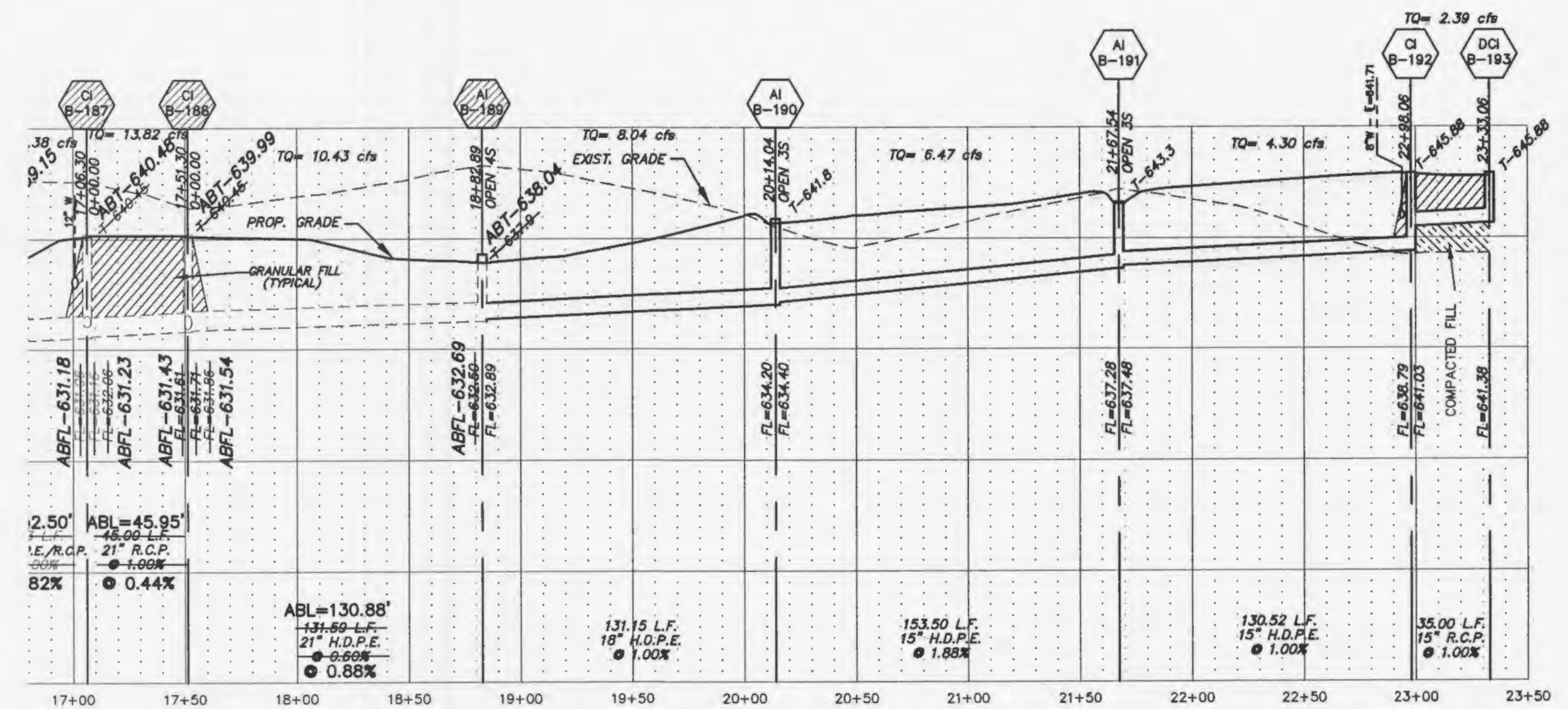

PROJECT TITLE
**WYNDGATE VILLAGE B
PLAT TWO**

PICKETT, RAY & SILVER INC
CIVIL ENGINEERING, LAND SURVEYING,
AND NATURAL RESOURCES SERVICES

Bl. Peabody
110 West Adams, Suite 201
Shelton, MD 20686

Phone (636) 397-1211 Fax (636) 397-1104
www.prs3.com 1-800-798-3918

ENGINEER'S AUTHORIZATION
THE RESPONSIBILITY FOR PROFESSIONAL
ENGINEERING LIABILITY ON THIS PROJECT
IS HEREBY LIMITED TO THE SET OF PLANS
AUTHENTICATED BY THE SEAL, SIGNATURE,
AND DATE HEREUNDER ATTACHED.
RESPONSIBILITY IS DISCLAIMED FOR ALL
OTHER ENGINEERING PLANS INVOLVED IN
THIS PROJECT AND SPECIFICALLY
EXCLUDES REVISIONS AFTER THIS DATE
UNLESS REVISIONS ARE
INITIALED AND SIGNED BY ME.

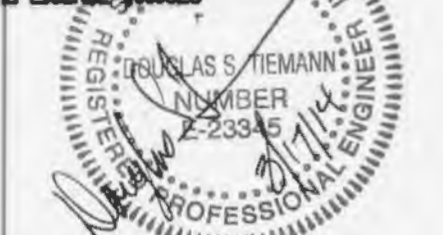

DOUGLAS S. TIEMANN
PROFESSIONAL ENGINEER LICENSE E-23345

Developer / Owner Information
McBride Wyndgate, LLC
16081 Swingley Ridge Road, Suite 300
Cheatfield, Missouri 63017

P+Z No. 3203

City No.

Page No.

9 of 24