

UTILITY NOTE:
UNDERGROUND FACILITY STRUCTURES AND UTILITIES HAVE BEEN PLOTTED FROM AVAILABLE SURVEYS AND RECORDED INFORMATION AND, THEREFORE, THEIR LOCATIONS MUST BE CONSIDERED APPROXIMATE ONLY. VERIFICATION OF LOCATION OF ALL UNDERGROUND STRUCTURES AND FACILITIES EITHER SHOWN OR NOT SHOWN ON THESE PLANS, SHALL BE THE RESPONSIBILITY OF THE CONTRACTOR.

NOTE: NEW CURB INLETS ARE TO BE EQUIPPED WITH TRITON® OR APPROVED EQUIVALENT WATER TREATMENT INSERTS. UNITS ARE TO BE INSTALLED AFTER ALL HOME CONSTRUCTION IN DRAINAGE AREA IS COMPLETE AND SITE IS STABILIZED. SEE DETAIL SHEET 30.

NOTE: ALL UTILITIES AND CONDUIT FOR UTILITIES SHALL BE PLACED A MINIMUM OF THREE (3) FEET BELOW THE PAVEMENT.

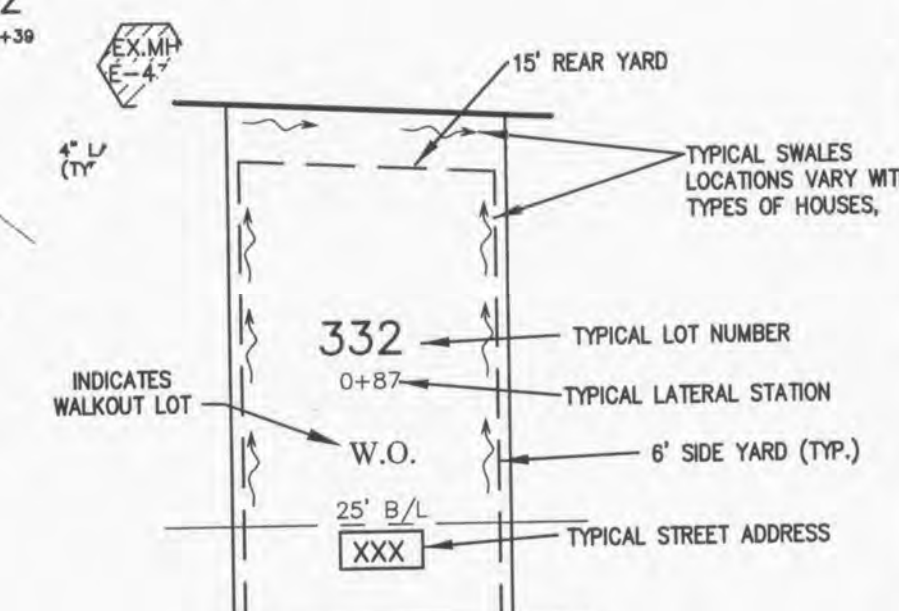
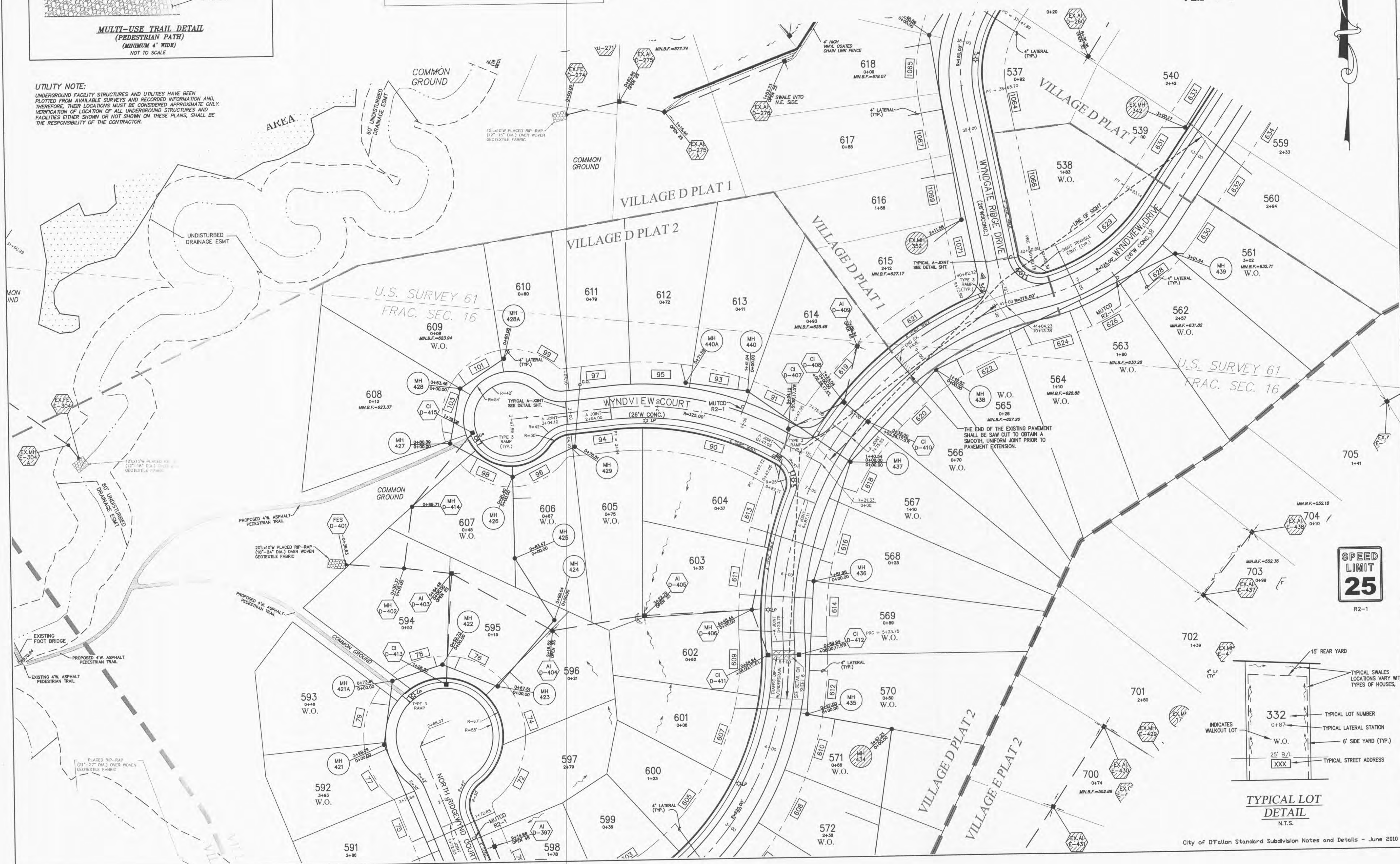
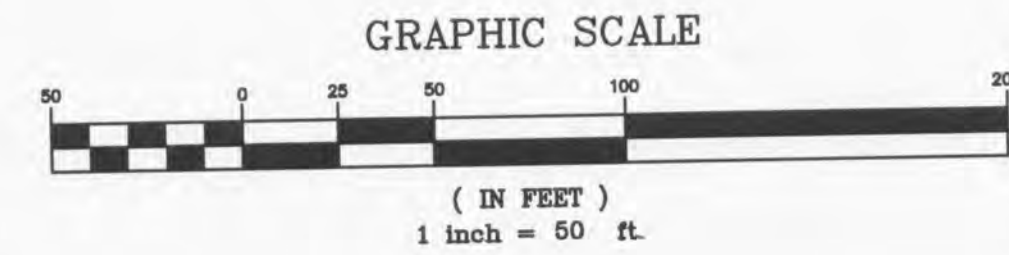

City of O'Fallon Standard Subdivision Notes and Details - June 2010

PROJECT TITLE
WYNDGATE VILLAGE D
PLAT TWO

PICKETT, RAY & SILVER INC
CIVIL ENGINEERING, LAND SURVEYING,
AND NATURAL RESOURCES SERVICES
Brenton Suite 201
110 W. Main Street
Brenton, MO 64616
St. Peters
22 S. Main Street
St. Peters, MO 65370
Phone (636) 397-1211 Fax (636) 397-1104
www.prs3.com 1-800-708-3916

ENGINEERS AUTHENTICATION
THE RESPONSIBILITY FOR PROFESSIONAL ENGINEERING LIABILITY ON THIS PROJECT IS HEREBY LIMITED TO THE SET OF PLANS AUTHENTICATED BY THE SEAL, SIGNATURE, AND DATE HEREUNDER ATTACHED. RESPONSIBILITY IS DISCLAIMED FOR ALL OTHER ENGINEERING PLANS INVOLVED IN THIS PROJECT AND SPECIFICALLY EXCLUDES REVISIONS AFTER THIS DATE UNLESS REAUTHENTICATED.
PICKETT, RAY & SILVER INC
NO LICENSE NUMBER
DOUGLAS S. TIEMANN
NUMBER
E-23345
DOUGLAS S. TIEMANN
PROFESSIONAL ENGINEER LICENSE E-23345

Developer / Owner Information
McBride Wyndgate, LLC
16091 Swingley Ridge Road, Suite 300
Chesterfield, Missouri 63017

P+Z No. 3203
City No.
Page No. 3 of 30

CITY OF O'FALLON SITE PLAN