

UTILITY OWNERS

AT&T COMMUNICATIONS
402 NORTH 3RD STREET
ST. CHARLES, MO. 63301
CONTACT: DENNIS O'LEARY
636-949-1303

CENTURY TEL COMMUNICATIONS
1151 CENTURY TEL DRIVE
WENTZVILLE, MO. 63385
CONTACT: MARCIA GAY
636-332-7261

LACLEDE GAS COMPANY
4701 SOUTH BROADWAY
ST. LOUIS, MO. 63111
CONTACT: KIRK PRENGER
314-658-5549

AMEREN UE
1901 CHATEAU AVENUE
ST. LOUIS, MO. 63166
CONTACT: JEFF BUTLER
636-639-8311

CHARTER COMMUNICATIONS
941 CHARTER COMMONS
ST. LOUIS, MO. 63011
CONTACT: LARRY SAAFIR
636-220-2174

ALLIANCE WATER
410 EAST ELM STREET
O'FALLON, MO. 63366
CONTACT: DAN SCHERER
636-281-2858 EXT. 112

CITY OF O'FALLON, MISSOURI
PRELIMINARY PLANS
VETERANS MEMORIAL PARKWAY
ST. CHARLES COUNTY
SEPTEMBER 24, 2007

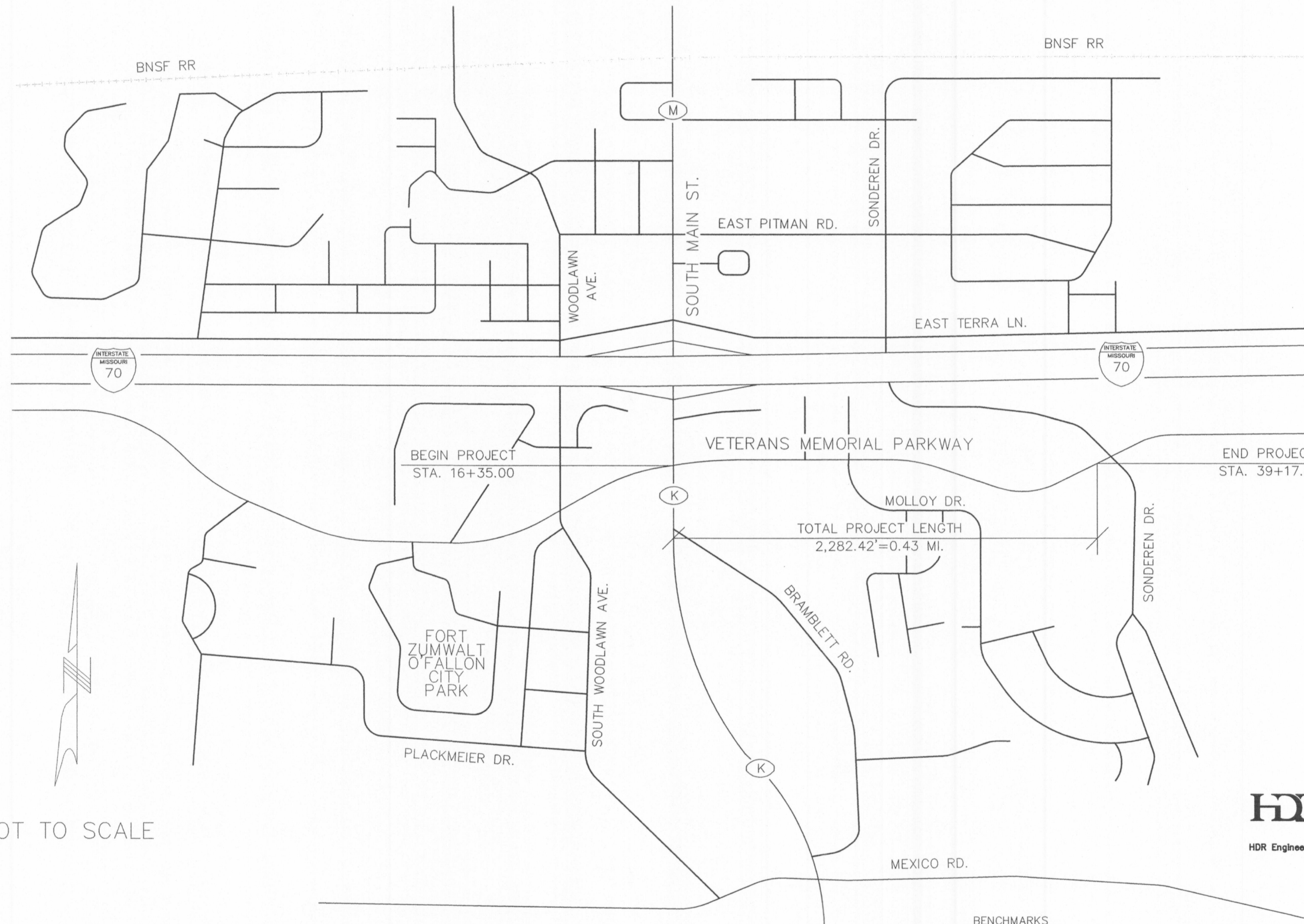

NOT TO SCALE



CONVENTIONAL SYMBOLS
(USED IN PLANS)

| | EXISTING | NEW |
|------------------------------|----------|----------|
| BUILDINGS AND STRUCTURES | [Symbol] | [Symbol] |
| GUARD RAIL | [Symbol] | [Symbol] |
| CONCRETE RIGHT-OF-WAY MARKER | [Symbol] | [Symbol] |
| STEEL RIGHT-OF-WAY MARKER | [Symbol] | [Symbol] |
| LOCATION SURVEY MARKER | [Symbol] | [Symbol] |
| UTILITIES | | |
| FIBER OPTICS | -FO- | +FO+ |
| OVERHEAD TELEPHONE | -O- | +O+ |
| UNDERGROUND TELEPHONE | -T- | +T+ |
| OVERHEAD POWER | -P- | +P+ |
| UNDERGROUND POWER | -G- | +G+ |
| GAS | -W- | +W+ |
| WATER | | |
| MANHOLE | [Symbol] | [Symbol] |
| FIRE HYDRANT | [Symbol] | [Symbol] |
| WATER VALVE | [Symbol] | [Symbol] |
| WATER METER | [Symbol] | [Symbol] |
| DROP INLET | [Symbol] | [Symbol] |
| DITCH BLOCK | [Symbol] | [Symbol] |
| GROUND MOUNTED SIGN | [Symbol] | [Symbol] |
| LIGHT POLE | [Symbol] | [Symbol] |
| H-FRAME POWER POLE | [Symbol] | [Symbol] |
| TELEPHONE PEDESTAL | [Symbol] | [Symbol] |
| FENCE | | |
| CHAIN LINK | [Symbol] | [Symbol] |
| WOVEN WIRE | [Symbol] | [Symbol] |
| GATE POST | [Symbol] | [Symbol] |
| BENCHMARK | [Symbol] | [Symbol] |
| SLOPE LIMITS | | |
| IN CUT | [Symbol] | [Symbol] |
| IN FILL | [Symbol] | [Symbol] |
| IN TRANSITION | [Symbol] | [Symbol] |

NOTE: DASHED OR OPEN SYMBOLS INDICATE EXISTING FEATURES

UNDERGROUND FACILITIES, STRUCTURES, AND UTILITIES HAVE BEEN PLOTTED FROM AVAILABLE SURVEYS AND RECORDS. THE COMMISSION DOES NOT WARRANT THE LOCATIONS OF THESE FACILITIES AS PRECISE. IT IS POSSIBLE THERE MAY BE OTHERS. THE EXISTENCE OF WHICH IS PRESENTLY NOT KNOWN OR SHOWN. IT IS THE CONTRACTOR'S RESPONSIBILITY TO DETERMINE THE EXISTENCE AND PRECISE LOCATION OF ALL FACILITIES AND TO AVOID DAMAGE TO THEM. SEE THE JOB SPECIAL PROVISIONS FOR A LIST OF UTILITY COMPANIES ON OR WITHIN THE VICINITY OF THE PROJECT LIMITS.

ENGINEER'S AUTHENTICATION
THE RESPONSIBILITY FOR PROFESSIONAL ENGINEERING LIABILITY ON THIS PROJECT IS HEREBY LIMITED TO THIS SET OF PLANS AUTHENTICATED BY THE SEAL, SIGNATURE, AND DATE HERUNDER ATTACHED. RESPONSIBILITY IS DISCLAIMED FOR ALL OTHER ENGINEERING PLANS INVOLVED IN THIS PROJECT AND SPECIFICALLY EXCLUDES REVISIONS AFTER THIS DATE UNLESS REAUTHENTICATED.
HDR ENGINEERING, INC.

- REFERENCE BENCHMARK F149 ELEV 542.80 NAVD88 DATUM DESCRIBED BY NATIONAL GEODETIC SURVEY 1949. AT O'FALLON, ST. CHARLES COUNTY, MISSOURI ON THE WABASH RAILROAD, ONE BLOCK EAST OF THE STATION, IN THE SOUTHEAST CORNER OF ST. MARY INSTITUTE YARD (NOW O'FALLON CITY HALL), 40 FEET EAST OF THE CENTER OF HIGHWAY M AND 45 FEET NORTH OF THE CENTERLINE OF THE MAIN TRACK. A STANDARD DISK STAMPED F 149 1935 AND SET IN THE TOP OF A CONCRETE POST PROJECTING 6 INCHES ABOVE GROUND.
- SITE BENCHMARK ELEV. 578.46 OLD CROSS ON THE BACK OF CURB, 20"± SOUTH OF THE CENTERLINE OF THE ENTRANCE TO #801 HIGHWAY K AND 50"± WEST OF THE CENTERLINE OF HIGHWAY K.
- SITE BENCHMARK ELEV. 582.16 CHISELED "L" ON THE NORTHEAST CORNER OF HEADWALL, 23'± SOUTH OF THE CENTERLINE OF VETERANS MEMORIAL PARKWAY AND 58'± EAST OF MOLLOY DRIVE, AND NORTH OF LOT 1 OF "SPRING HILL"

| | | |
|--------------|--------|----------|
| ROUTE | STATE | DISTRICT |
| | MO | |
| BID # | | |
| CITY PROJ. # | 07-002 | |
| HDR PROJ. # | 60104 | |
| REV # | 0 | |

INDEX OF SHEETS

| DESCRIPTION | SHEET NUMBER |
|----------------------------|--------------|
| TITLE SHEET | 1 |
| TYPICAL SECTIONS (1 SHEET) | 2 |
| PLAN - PROFILE | 3-8 |
| TRAFFIC CONTROL | 9-10 |
| CROSS SECTIONS | 11-23 |
| ENTRANCE PROFILES | 24-32 |

LENGTH OF PROJECT

| | |
|--------------------------|-----------------|
| BEGINNING OF PROJECT | STA. 16 + 35.00 |
| END OF PROJECT | STA. 39 + 17.42 |
| APPARENT LENGTH | 2,282.42 FEET |
| EQUATIONS AND EXCEPTIONS | |
| TOTAL CORRECTIONS | 0.00 FEET |
| NET LENGTH OF PROJECT | 2,282.42 FEET |
| STATE LENGTH | 0.432 MILES |

SURVEY PREPARED BY:

MARK E. COLLINS
PROFESSIONAL LAND SURVEYOR
BAX ENGINEERING COMPANY, INC.
221 POINT WEST BOULEVARD
ST. CHARLES, MO 63301
(636) 928-5552

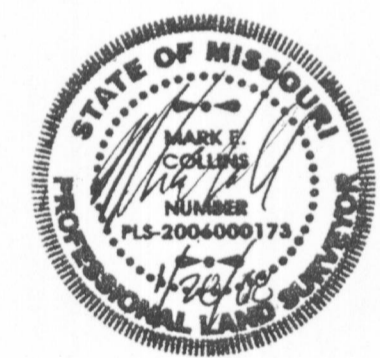

DATE _____