

NOTE:  
EXISTING GRAVEL DRIVES TO BE REPLACED WITH MINIMUM  
6\"/>

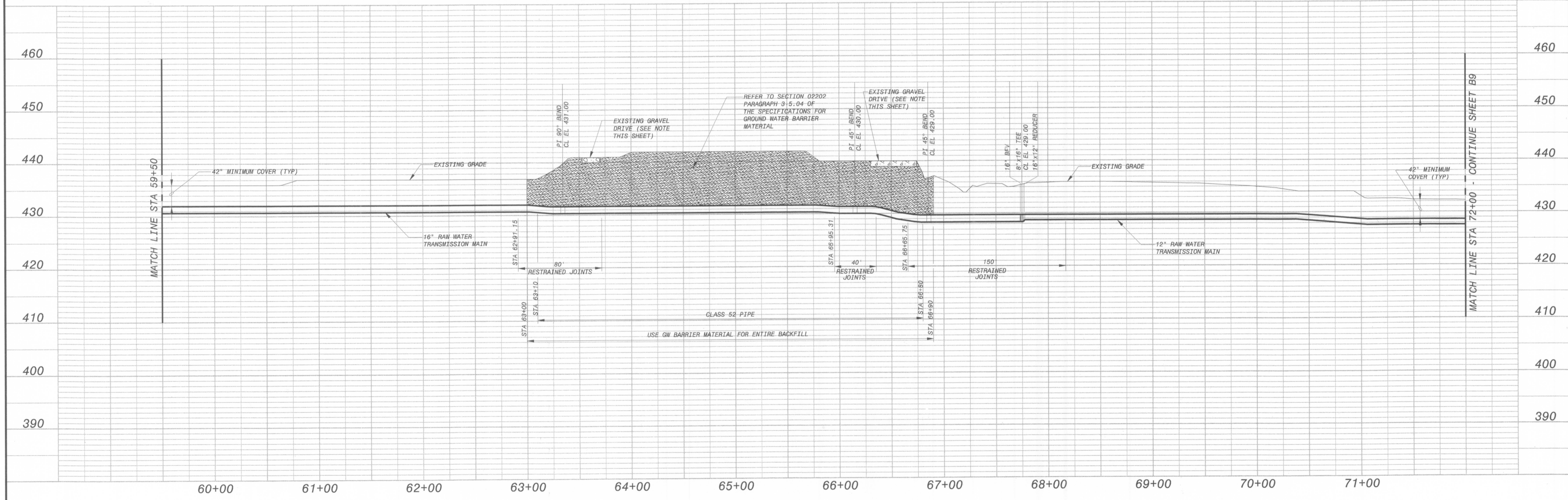

| NO. | DATE | REVISIONS AND RECORD OF ISSUE | NO. | BY | CHK. | APP. |
|-----|------|-------------------------------|-----|----|------|------|
| 1   |      |                               |     |    |      |      |
| 2   |      |                               |     |    |      |      |
| 3   |      |                               |     |    |      |      |
| 4   |      |                               |     |    |      |      |
| 5   |      |                               |     |    |      |      |



**CITY OF FALLON, MISSOURI**  
**WELL FIELD AND RAW WATER**  
**TRANSMISSION MAIN**  
 STA 59+50 TO STA 72+00

DESIGNED: BPF  
 DETAILED: DPH, CSA  
 CHECKED: RFS  
 APPROVED: KMN  
 DATE: 3-7-02

PROJECT NO.  
**97515**

**B8**  
 SHEET  
 9 OF 15